

9 LISTA PARTI

9 PART LIST

9 LISTE DE PIÈCES

9 LISTA PARTI

9 LISTA PARTI

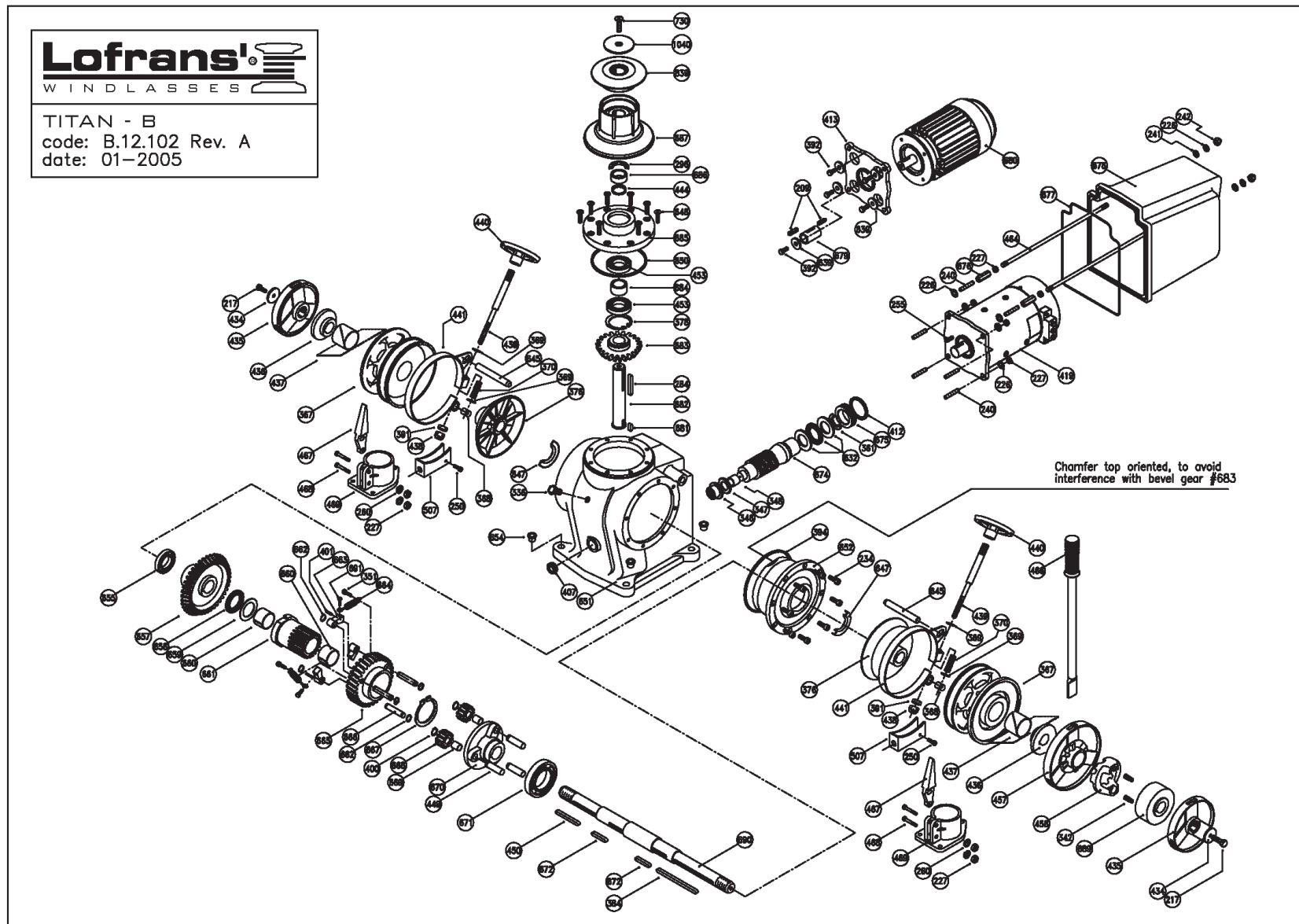

9 LISTA PARTI

9 PART LIST

9 LISTE DE PIECES

9 LISTA PARTI

9 LISTA PARTI

TITAN - B

Item	Description	Kit	Qty	Item	Description	Kit	Qty
209	Key - 6x6x30	Kit C	2	657	Bevel gear		1
217	Hex hd screw M8x20	Kit B	2	658	Thrust bearing - AX 4060		1
226	Washer for screw M8	Kit B	8	659	Thrust ring - CP 4060		1
227	Nut - M8	Kit B	10	660	Bush		2
234	Hd cap screw - M8x20	Kit B	8	661	Ratchet wheel		1
240	Stud - M8x45	Kit B	6	662	Circlip - 12 Din 471	Kit D	6
241	Nylon washer M8	Kit B	2	663	Pawl		3
242a	Cap nut M8	Kit B	2	664	Spring		3
250	Hd cap screw - M5x8	Kit B	2	665	Wormwheel		1
255	Key - 6x6x25	Kit C	1	666	Pivot		3
280	Spring washer for screw M8	Kit B	4	667	Circlip - 68 Din 471	Kit D	1
284	Key - 8x7x60	Kit C	1	668	Gear		3
336	Seal - 40x56x8	Kit A	1	669	Bush		3
342	Oil plug 3/8"		1	670	Gear flange		1
348	Combined bearing - Rax 720		2	671	Bearing - 6011		1
347	Thrust ring - CP 32035		1	672	Key - 8x7x50	Kit C	2
348	Ring IM 1520164		1	674	Worm		1
351	Hd cap screw - M8x20	Kit B	3	675	Spacer		1
361	Seal - 40x50x5	Kit A	1	676	Spacer		2
367a	Gipsy chain 8 Iso	Kit A	1	677	Gasket		1
367b	Gipsy chain 10 Iso - 3/8" C40		2	678a	Motor cover		1
367c	Gipsy chain 3/8" Din766 - BBB - 10 Din766		2	678b	White motor cover		1
367d	Gipsy chain 1/2" C40		2	679	Coupling		1
367e	Gipsy chain 1/2" BBB		2	681	Key - 8x7x20	Kit C	1
367f	Gipsy chain 1/2" C40		2	682	Shaft		1
367g	Gipsy chain 1/4 Iso		2	683	Bevel gear		1
367h	Gipsy chain 10 Iso		2	684	Spacer		1
367i	Gipsy chain 3/8" C40		2	685	Cover		1
368	Pivot		2	686	Spacer		1
369	Washer for screw M10	Kit B	4	687	Chromed bronze drum-lower part		1
370	Spring		2	689	Bush		1
376	Clutch cone - inner		2	690	Main shaft		1
378	Circlip - 62 Din 472	Kit D	1	691	Hd cap screw - M5x12	Kit B	3
384	Key - 8x7x140	Kit C	1	730	Conic hd screw M10x30	Kit B	1
391	Nut - M10	Kit B	2	839a	Chromed bronze drum-upper part		1
392	Hex hd screw M8x25	Kit B	5	1040	Washer		1
394	O Ring seal - 4825	Kit A	1				
400	Circlip - 15 Din 471	Kit D	3				
401	Pivot		3				
407	Sightglass		1				
412	O Ring seal - 163	Kit A	1				
413	Coupling flange		1				
419	Electric motor 2000W 24V		1				
434	Washer	Kit B	2				
435	Wingnut		2				
436	Clutch cone - outer		2				
437a	Nylon band for chain Ø8		2				
437c	Nylon band for chain Ø10		2				
438	Safety nut M10	Kit B	2				
439	Brake pivot		2				
440	Hand-wheel		2				
441	Band brake		2				
444	O Ring seal - 4112	Kit A	1				
448	Pivot		3				
450	Key - 8x7x80	Kit C	1				
453	Bearing - 6206		2				
457	Emergency wheel		1				
458	Dog clutch		1				
464	Stud - M8x285		2				
466	Handle		1				
467	Stripper		2				
468	Hex hd screw M8x40	Kit B	4				
469	Chain pipe		2				
507a	Brake cover		2				
632b	Thrust bearing - 51108		1				
639	Washer for screw M8	Kit B	5				
645	Brake pivot		2				
647	Seal - 35x65x10	Kit A	2				
648	Hd cap screw - M8x20	Kit B	8				
651	Gasket		1				
651	Body		1				
652	Rack		1				
654	Nylon bush		4				
655	Bearing - 6207		1				

B. 12.102 - Rev. A Date: 01-2005