

THE MOST EFFICIENT UNIT FOR CONVERTING AN ICEBOX OR INSULATED CAVITY INTO A GOOD REFRIGERATOR.

D.C. REFRIGERATION

FRIGOMATIC K35F & K50F

- Water cooling with keel cooler saves more than 20% compared to air cooling.
- Keel cooler eliminates the need of independent sea water pump.
- Danfoss compressor of the latest generation with electrical consumption 25% lower compared to other compressor concepts.
- Extremely compact dimensions.
- Maximum efficiency.
- Precharged system equipped with Frigoboat self sealing couplings.
- Configuration with evaporators for fridges up to 350 litres (12 cu.ft.) and freezers up to 80 litres (2.8 cu.ft.).
- Version with holding plate for fridges up to 160 litres.
- Automatic battery protection.
- Optional 230V automatic mains adaptor.

-25%



Automatically runs on either 12 to 24 Volts



THE KEEL COOLER IS MANUFACTURED FROM MARINE GRADE BRONZE WITH CUPRO-NIKEL PIPING.

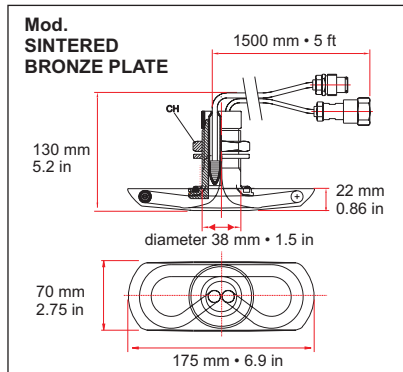
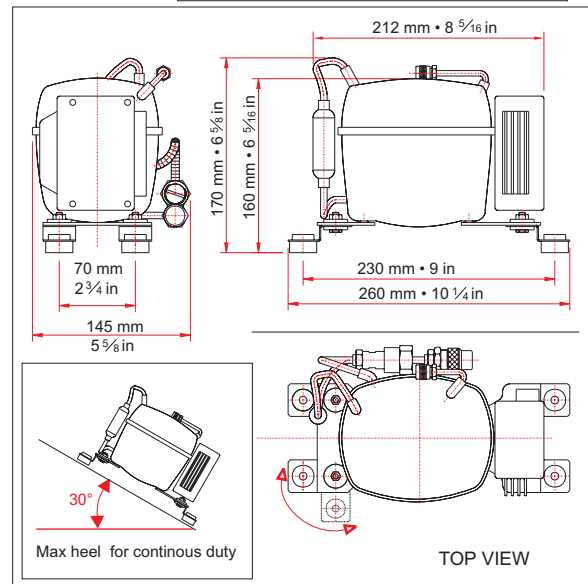

ALL MODELS AVAILABLE WITH ZINC ANODES (add Z to part N.)

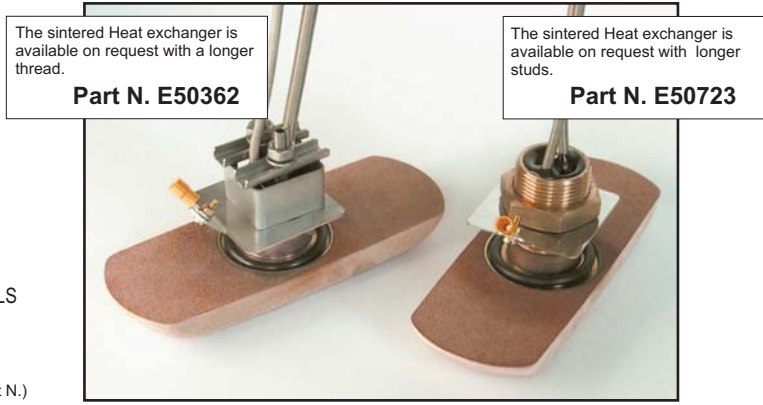

The sintered Heat exchanger is available on request with a longer thread. Part N. E50362

The sintered Heat exchanger is available on request with longer studs. Part N. E50723

Part N. E50361
THREAD MOUNT

Part N. E50722
STUD MOUNT

D.C. REFRIGERATION

PRECHARGED EXTENSIONS
(Options)

COMPRESSOR SIDE EVAPORATOR SIDE

L	Part N..
1m•3ft	E50255
2m•6ft	E50260
3m•10ft	E50265
4m•13ft	E50270
5m•16ft	E50275
6m•20ft	E50280

Automatic mains adaptor 230V **E51305**

Vertical ice tray single **A090400** double **A090500**

FRIGOMATIC K35F & K50F

SYSTEM CONFIGURATION

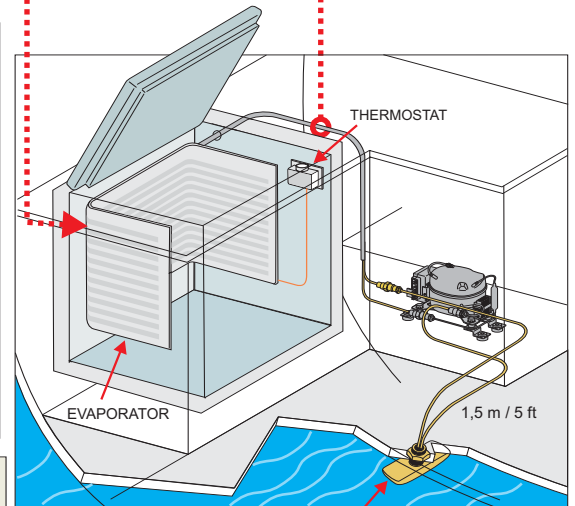

TABLE OF EVAPORATOR COMPATIBILITY

EVAPORATOR MODEL	Part N.	MAXIMUM CAPACITY LITRES/cu.ft.		DIMENSIONS (mm•in)					
		FRIDGE	RPM*	FREEZER	RPM*	WIDTH	DEPTH	HEIGHT	
FRIGOMATIC K 35F	130H	E50065	120•4.2	2500	50•1.8	3000	255•10	210•8.26	70•2.75
	160H	E50090	160•5.6	2500	60•2.1	3000	320•12.6	210•8.26	115•4.52
	80F	E50881	80•2.8	2000	----	----	330•13	-----	245•9.65
	130F	E50085	160•5.6	2500	60•2.1	3000	590•23.22	-----	210•8.26
	160F	E50095	180•6.3	2500	70•2.5	3500	805•31.7	-----	210•8.26
FRIGOMATIC K 50 F	200H	E50070	200•7	3000	80•2.8	3500	360•14.17	270•10.63	150•5.9
	200F	E50075	240•8.5	3000	80•2.8	3500	1020•40.15	-----	270•10.63
	200B	E50100	220•7.8	3000	80•2.8	3500	325•12.8	245•9.65	270•10.63
	340B	E50105	340•12	3500	80•2.8	3500	380•15	150•5.9	290•11.41

*RPM = SUGGESTED COMPRESSOR SPEED

TECHNICAL CHARACTERISTICS

	35F	50F	35F	50F	35F	50F	35F	50F
Compressor speed RPM	2000	2000	2500	2500	3000	3000	3500	3500
Capacity (+35°/ -10°C) Btu/h	290	330	360	420	415	492	480	570
Consumption in Amp (12V)	2,53	3,67	3,36	4,68	3,93	5,68	4,63	6,80
Consumption in W	30	44	40	56	47	66	56	81

Weight	5,8 Kg • 12.7 lbs
Shipping weight	6,6 Kg • 14.5 lbs

SUPPLY TOLERANCE

12 V	24 V
10.5 - 17 V	21 - 32 V

THERMOSTAT

FRIDGE
Part N. **E250500**

FREEZER
Part N. **E250700**

DOUBLE
Part N. **E261300**

FOR HOLDING PLATES
Part N. **A020300**

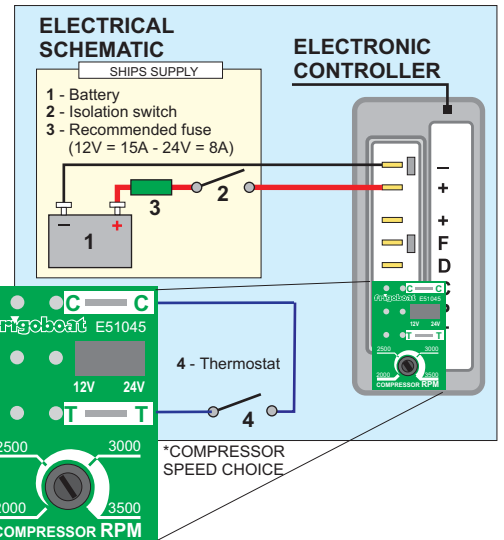

ELECTRICAL CABLES TABLE

Size	mm ²	Awg	max distance			
			12 V		24 V	
	2,5	14	2,5	8.2	5	16.4
	4	12	4	13.1	8	26.2
	6	10	6	19.6	12	39.4
	10	8	10	32.8	20	65.6

D.C. REFRIGERATION COMPRESSORS

FOR FRIGDES UP TO 3.5 cu.ft / 100 lt	ROMA 35F PARIS 35F MADRID 35F	FOR FRIGDES UP TO 14.2 cu.ft 400 lt	SUPERFRIGOMATIC KW 50 F SUPERFRIGOMATIC K 50 F
FOR FRIGDES UP TO 5.6 cu.ft / 160 lt	CAPRI 35 F MALTA 35F		
FOR FRIGDES UP TO 12 cu.ft / 340 lt	CAPRI 50 F		
FOR FRIGDES UP TO 12 cu.ft 340 lt	AV35F AH35F W35F - W50F K35F - K50F		

HOLDOVER PLATE SYSTEMS

Engine driven Series 2000

Holding plates