

Portata/Lifting capacity (Kg)	100
A (mm)	500x300x10
B (mm)	Ø 300
h (mm)	520
H (mm)	765
t (mm)	Ø 100
T (mm)	Ø 130
Peso / Weight (Kg)	115

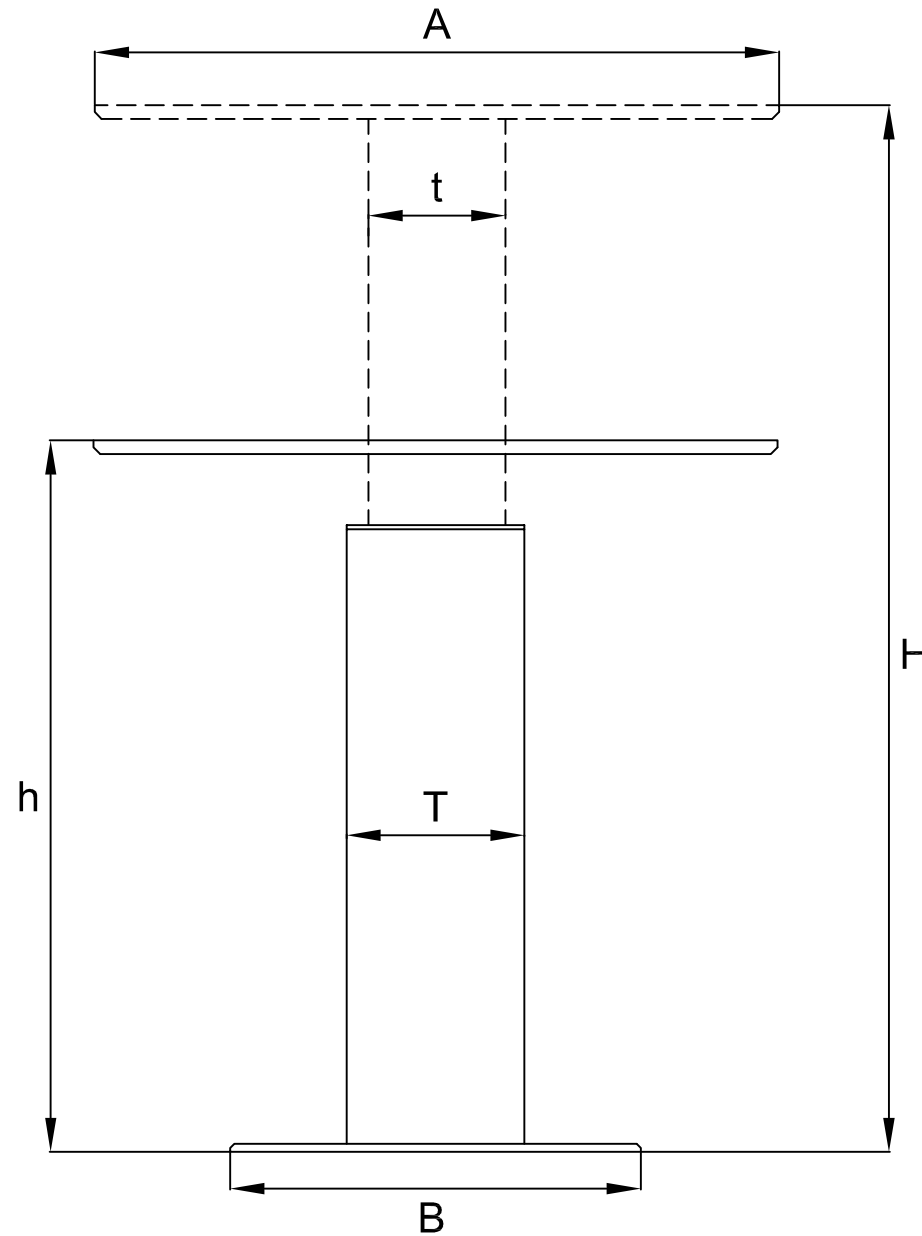

Codice / Code

T 271

Supporto tavolo manuale
Manual table pedestal