

9 LISTA PARTI

9 PART LIST

9 LISTE DE PIECES

9 LISTA PARTI

9 LISTA PARTI

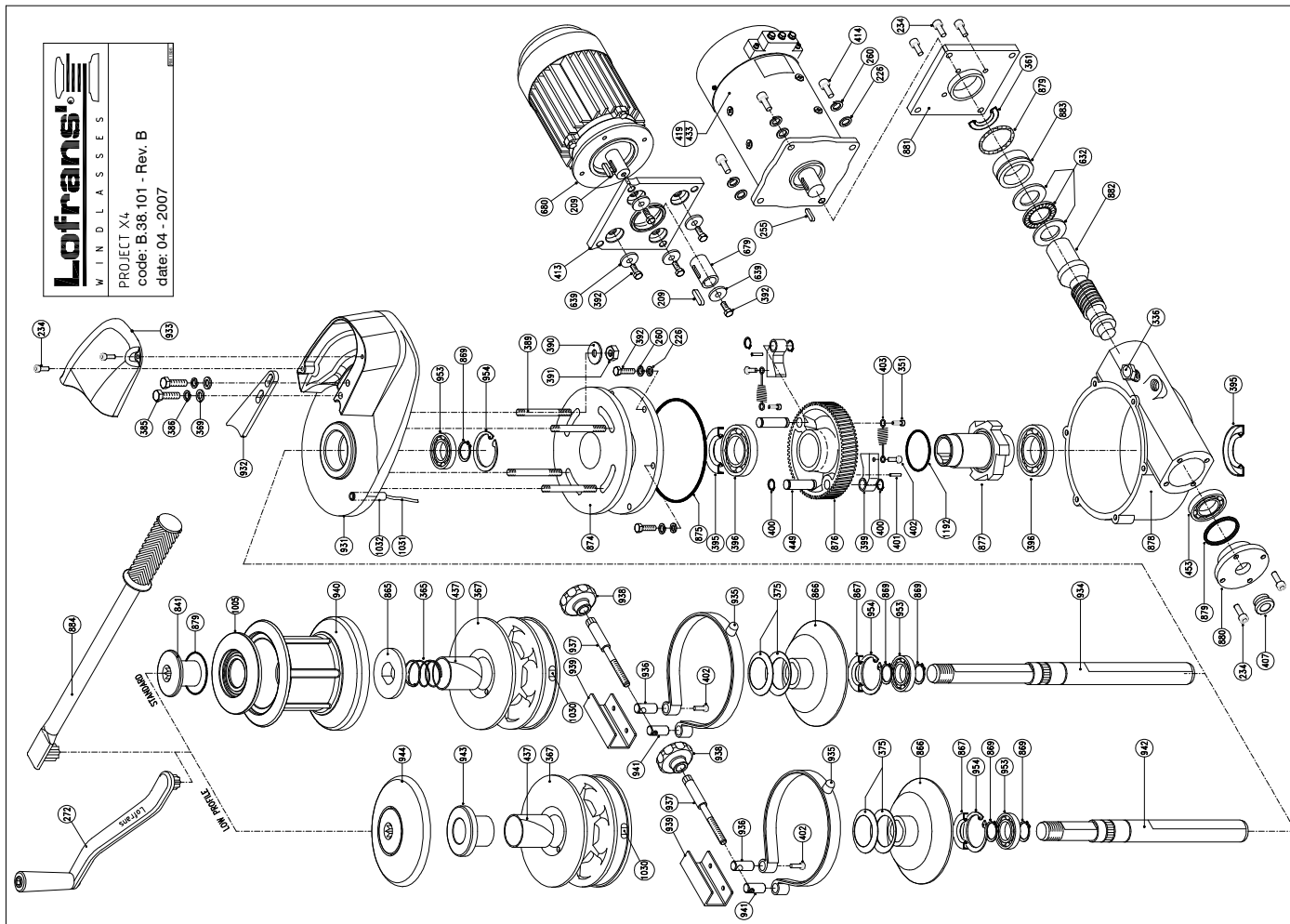

9 LISTA PARTI

9 PART LIST

9 LISTE DE PIECES

9 LISTA PARTI

9 LISTA PARTI

PROJECT X4

Item	Description	Kit	Qty	Item	Description	Kit	Qty
209	Key - 6x6x30	Kit C	2	954	Circlip - 68 Din-472 inox	Kit D	2
226	Washer for screw M8	Kit B	10	1005	Drum washer		1
234	Hex cap screw - M8x20	Kit B	10	1030	Magnet	Kit S	1
255	Key - 6x6x25	Kit C	1	1031	Sensor	Kit S	1
260	Spring washer for screw M8	Kit B	10	1032b	Sensor tube		1
272	Handle		1	1192	O Ring seal - 60-5 special		1
336	Oil plug 3/8"		1				
351	Hex cap screw - M8x20	Kit B	2	KA26101	Kit A - Seals		1
361	Seal - 40x50x5	Kit A	1	K926101	Kit B - Screws&Nuts		1
365	Spring		1	KC26101	Kit C - Keys		1
367b	Gipsy chain 10 Iso - 3/8 G40		1	KD26101	Kit D - Circlips		1
367c	Gipsy chain 3/8 Din766 - BBB - 10 Din766		1	KS38101	Kit S - Sensor&magnet		1
367d	Gipsy chain 12 Iso - 13 Din766 - 1/2Din766		1				
367e	Gipsy chain 1/2 G40		1				
367f	Gipsy chain 1/2 BBB		1				
367g	Gipsy chain 1/4 Iso		1				
369	Washer for screw M10	Kit B	2				
375	Disner plane spring		2				
385	Hex hd screw M10x30	Kit B	2				
386	Spring washer for screw M10	Kit B	2				
389b	Stud - M10x170		4				
390	Washer	Kit B	4				
391	Nut - M10	Kit B	4				
392	Hex hd screw - M8x25	Kit B	11				
395	Seal - 50x70x10	Kit A	2				
396	Bearing - 16010		2				
399	Pawl		2				
400	Circlip - 15 Din 471	Kit D	4				
401	Pivot		2				
402	Hex hd screw - M6x16	Kit B	3				
403	Spring		2				
407	Signiglass		1				
413	Coupling flange		1				
414	Hex hd screw - M8x30	Kit B	4				
419	Electric motor 2000 W 24 V		1				
433	Electric motor 2500 W 24 V		1				
437	Nylon band		1				
449	Pivot		2				
453	Bearing - 6206		1				
622b	Bearing - 51108		1				
639	Washer for screw M8	Kit B	5				
679	Coupling		1				
680	A.C. Electric motor		1				
841	Clutch nut		1				
865	Clutch cone - outer		1				
866	Clutch cone - inner		1				
867	Seal - 40x68x10	Kit A	1				
869	Circlip - 40 Din 471	Kit D	3				
874	Gearcase - upper		1				
875	O Ring seal - 4600	Kit A	1				
876	Wormwheel		1				
877	Ratchet		1				
878	Gearcase - lower		1				
879	O Ring seal - 159	Kit A	3				
880	Oil level flange		1				
881	Coupling flange		1				
882	Worm		1				
883	Spacer		1				
884	Emergency handle		1				
931	Base		1				
932	Stripper		1				
933	Cover		1				
934	Main shaft		1				
935	Band brake		1				
936	Pivot		1				
937	Brake pivot		1				
938	Knob		1				
939	Brake cover		1				
940	Drum		1				
941	Pivot		1				
942	Main shaft		1				
943	Clutch cone - outer		1				
944	Gipsy cap		1				
953	Bearing - 6008-2RS inox		2				

B.38.101 Rev. B - Date: 04-2007

9 LISTA PARTI

9 PART LIST

9 LISTE DE PIECES

9 LISTA PARTI

9 LISTA PARTI

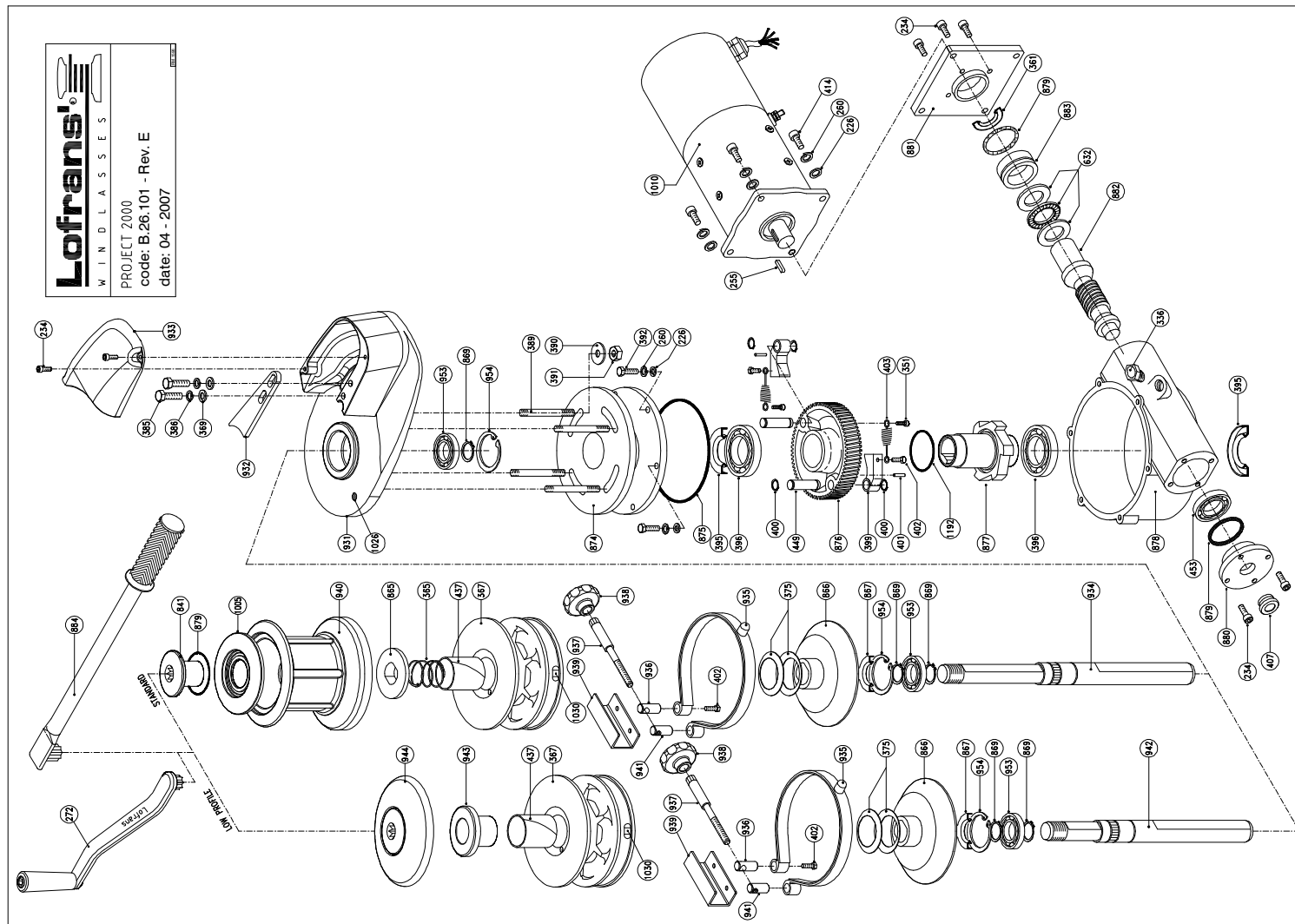

PROJECT 2000

9 LISTA PARTI

9 PART LIST

9 LISTE DE PIECES

9 LISTA PARTI

9 LISTA PARTI

Item	Description	Kit	Q.ty	Item	Description	Kit	Q.ty
226	Washer for screw M8	Kit B	10	KA26101			
234	Hd cap screw - M8x20	Kit B	10	KB26101	Kit A - Seals		1
255	Key - 6x6x25	Kit C	1	KC26101	Kit B - Screws&Nuts		1
260	Spring washer for screw M8	Kit B	10	KD26101	Kit C - Keys		1
272	Handle		1		Kit D - Circlips		
336	Oil plug 3/8"		1				
351	Hd cap screw - M6x20	Kit B	2				
361	Seal - 40x50x5	Kit A	1				
365	Spring		1				
367b	Gipsy chain 10 iso - 3/8 G40		1				
367c	Gipsy chain 3/8 Din766 - BBB - 10 Din766		1				
367d	Gipsy chain 12 iso - 13 Din766 - 1/2Din766		1				
367e	Gipsy chain 1/2 G40		1				
367f	Gipsy chain 1/2 BBB		1				
367g	Gipsy chain 14 iso		1				
369	Washer for screw M10	Kit B	2				
375	Dished plane spring		2				
385	Hex hd screw M10x30	Kit B	2				
386	Spring washer for screw M10	Kit B	2				
386b	Stud - M10x170		4				
390	Washer	Kit B	4				
391	Nut - M10	Kit B	4				
392	Hex hd screw - M8x25	Kit B	6				
395	Seal - 50x70x10	Kit A	2				
396	Bearing - 16010		2				
399	Pawl		2				
400	Circlip - 13 Din 471	Kit D	4				
401	Pivot		2				
402	Hex hd screw - M6x16	Kit B	3				
403	Spring		2				
407	Sightglass		1				
414	Hex hd screw - M8x30	Kit B	4				
437	Nylon band		1				
449	Pivot		2				
453	Bearing - 6206		1				
632b	Bearing - 51108		1				
841	Clutch nut		1				
865	Clutch cone - outer		1				
866	Clutch cone - inner		1				
867	Seal - 40x68x10	Kit A	1				
869	Circlip - 40 Din 471	Kit D	3				
874	Gearcase - upper		1				
875	O Ring seal - 4800	Kit A	1				
876	Wormwheel		1				
877	Ratchet		1				
878	Gearcase - lower		1				
879	O Ring seal - 159	Kit A	3				
880	Oil lever flange		1				
881	Coupling flange		1				
882	Worm		1				
883	Spacer		1				
884	Emergency handle		1				
931	Base		1				
932	Stripper		1				
933	Cover		1				
934	Main shaft		1				
935	Band brake		1				
936	Pivot		1				
937	Brake pivot		1				
938	Knob		1				
939	Brake cover		1				
940	Drum		1				
941	Pivot		1				
942	Main shaft		1				
943	Clutch cone - outer		1				
944	Gipsy cap		1				
953	Bearing - 6008-2RS inox		2				
954	Circlip - 68 Din 472 inox	Kit D	2				
1005	Drum washer		1				
1010	Electric motor 2000W 24V		1				
1026	Plastic cap for sensor		1				
1192	O Ring seal - 60-5 special		1				

B.26.101 - Rev. E Date: 04-2007